



[www.gosforthpark.newcastle.sch.uk](http://www.gosforthpark.newcastle.sch.uk)

April 26<sup>th</sup> 2024 Issue 2 Summer Term 1



It was so lovely to invite our KS2 parents into school this morning to see the children's new learning environment. The children were so enthusiastic in showing off our new spaces! It was great to see the community room in good use afterwards for teas and coffees. We have a couple of more dates planned in for you to join us below.

**Grandparents Coffee Morning** Wednesday  
8<sup>th</sup> May 9:00am – 10:00am

**Parents and Carers Coffee Morning** Friday  
17<sup>th</sup> May 9:00am – 10:00am



We are delighted that Annie and Gemma from RISE will be returning to work with us soon! They will be working with our year 4 children around transition and with some other groups and individuals in school.

They will also be running a series of parent/carers workshops from our lovely new community room! This will be starting a bit earlier to give you more time to chat before collecting the children. All workshops will be from 2:20pm – 3:20pm

Thursday 16<sup>th</sup> May – Anxiety

Thursday 23<sup>rd</sup> May – Emotional Regulation

Thursday 6<sup>th</sup> June – Sleep Hygiene

Thursday 13<sup>th</sup> June – Looking after our mental health.

## Building Update

We are delighted to have our new Wraparound space including its own entrance, kitchen and toilet. We are working on getting the huge planter removed from that front door! The children certainly seemed to feel at home pretty quickly and were loving sharing books in the new reading area.



Our Rainbow canopy and terrace are coming along nicely. The reflection on the flags is stunning when the sun is shining – we can't wait to use this space!

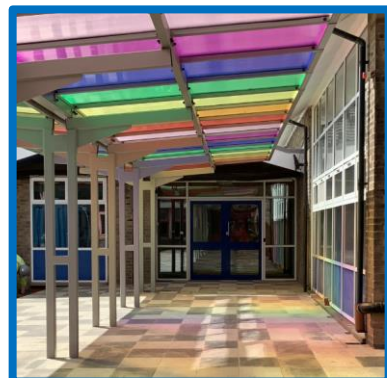

Builders currently have occupation of most of the old hall, down to and including old Green Class, and are busy stripping out and demolishing things to create our new counselling room, sensory room, teachers work room and KS1 practical room.



## Music Update

We are loving our latest Musician of the Half Term, Fleetwood Mac! I thought this may be a popular choice for parents. I can see in Violet Class that some of the songs must have been played at home over the years! We have started learning 'Everywhere' in singing assembly.

The 'Big Gig' will be held on the 21st June at the Vertu Motors Arena. More information about the event and buying tickets will be sent out via Parent Pay soon. This will be for all KS2 children. They will get the opportunity to play the Ukulele and sing along to a variety of songs. This year's theme is 'Hello Sunshine!'

Thank you  
Mr Patterson – Music Lead

## PTFA Meeting

**Next meeting:**  
**Tuesday 7<sup>th</sup> May from 6:15 - 7:15pm in the brand new community room!**

## New Nursery and Reception Parents

We are delighted to be welcoming a new cohort of Nursery and Reception children from September 2024. New Nursery and Reception parents should be receiving a welcome letter via email from the school office today. Please pop the key dates for welcome meeting and transition in your diary. Please make sure you have accepted your places as we do have waiting lists in all year groups.

## Uniform

In preparation for the introduction of our new logo in September, we have a number of brand new items with the current logo available for half price (cash only) at the school office.

Jumpers £4.50  
Cardigans £6.00  
Polo shirts £4.00

## New Community Room Opportunities

We'd love to hear your ideas for how you'd like to use our **community room**. We've had a few ideas and would love to get your views via this online form

<https://forms.office.com/e/SFsJ22b5zt>

Please pass it on to grandparents, childminders and anyone else you think would like to use the space!

# Congratulations!



Congratulations to **Max** who has achieved a black stripe on his Taekwondo belt! Max is very proud of this achievement and so are we – well done!



**Erin** had her Taekwondo grading and passed to become a green belt. She then competed in a competition this weekend with her new grade pattern and was placed 3rd. Well done Erin!



## Healthy School



Now the summer term has begun, we will hopefully see some better weather filled with warmth and sunshine! With this also brings the reminder to bring in our water bottles (water only please) to enable the children to remain hydrated. Our children love to be active on the yard and can get quite hot after a busy playtime and so it is extra important to remember our bottles in the summer months. Water not only quenches thirst but is important for brain function, improving memory and attention, reduces the risk for some chronic diseases in later life and aids digestion and bladder function.

Mrs Wells

### Reminder

Please be reminded that the last day of this term is Friday 24<sup>th</sup> May.

We return to school on **Tuesday 4<sup>th</sup> June.**



## Pre-Loved Uniform

PRE-LOVED ITEMS WE CAN SELL		PRE-LOVED ITEMS WE CAN NOT SELL
OFFICIAL SCHOOL JUMPERS	£2.50	NON – OFFICIAL JUMPERS
OFFICIAL SCHOOL CARIGANS	£2.50	NON – OFFICIAL CARIGANS
OFFICIAL SCHOOL POLOS	£1.50	NON – OFFICIAL POLOS
GIRLS CHECKED DRESSES	£1.50	GREY BOYS TROUSERS
GREY PINAFORES	£1.50	GREY TAYLORED GIRLS TROUSERS
GREY SKIRTS	£0.50	GREY BOYS SHORTS
GREY GIRLS SOFT TROUSERS	£0.50	DAMAGED OR MARKED ITEMS
SCHOOL BAG (NEW STYLE)	£2.50	
SCHOOL BAG (OLD STYLE)	£1.50	
OFFICIAL PE T-SHIRT/SHORTS	£0.50	

Items are sold from 1 Park Drive, Melton Park NE3 5QB, with a drop off box at the front door. Please REMEMBER items, particularly red, must not be marked as they are unable to be sold on. You can text me Natasha Davy (Parent) on 07736276653. All money made comes back to school to be spent on playground equipment for our wonderful children.

## Attendance

Our whole school attendance to date this academic year is **96.4%** up on **94.8%** last year.

Our classes of the week are **Orange Class** and **Violet Class** with **100%**!

Well done everyone!  
Mrs Lamb

## TIMES TABLES ROCK STARS

Congratulations **Violet Class** who have been **87%** active this week!

Well done to **Beanie** and **Mais** who recently became a rock star. Almost all of our Year 4s have a faster speed of 6 seconds now which is brilliant and will help you with the multiplication check. Our top coin earners this week are **Ava, Mais** and **Toby**.



Well done to **Orange class** who are our most active class this week.

Our activity across the school was down this week so don't forget to log on after school or this weekend to practice your number bond fluency.

Just 3 minutes a day for 3 days a week will improve your recall and help you in class solve trickier problems.

Our top coin earners this week are:

**Violet** – Erin P

**Indigo** – Elia S

**Yellow** – Patrick D

**Orange** – Alanna T

**Green** – Arisa K

**Reception (Miss Parsons Munn)** – Rosie R

**Reception (Miss Coughlan)** – Olivia G

Great job GPFS,  
Miss Pope.

# Advanced Notice of Dates 2023-2024

Updates will be added in red

	Easter Holiday
<b>Monday 15<sup>th</sup> April</b>	<b>School Closed</b>
Tuesday 16 <sup>th</sup> April	School reopens
Monday 29 <sup>th</sup> April	Reception Healthy Active Lifestyle Event
Wednesday 1 <sup>st</sup> May	KS1 Trip to Washington Wetlands
<b>Monday 6<sup>th</sup> May</b>	<b>May Bank Holiday</b>
Tuesday 7 <sup>th</sup> May	PTFA Meeting 6.15pm - 7.15pm
Wednesday 8 <sup>th</sup> May	Y2 Safety Works Trip 1-3pm
Friday 10 <sup>th</sup> May	Y4 Safety Works Trip 10-12
<b>Thursday 16<sup>th</sup> May</b>	<b>RISE Parent Carer Workshop: Anxiety</b>
Sunday 19 <sup>th</sup> May	Children's Cancer Run
<b>Thursday 23<sup>rd</sup> May</b>	<b>RISE Parent Carer Workshop: Emotional Regulation</b>
Friday 24 <sup>th</sup> May	Daft Day
Friday 24 <sup>th</sup> May	Last Day of Term
	May Half term Holiday
<b>Monday 3<sup>rd</sup> June</b>	<b>Training Day</b>
<b>Thursday 6<sup>th</sup> June</b>	<b>RISE Parent Carer Workshop: Sleep Hygiene</b>
Friday 7 <sup>th</sup> June	Wear Wellies Day
<b>Monday 10<sup>th</sup> June to Friday 14<sup>th</sup> June</b>	<b>Year 1 Phonics screening check</b>
Wednesday 12 <sup>th</sup> June	Year 4 Multiplication Tables Check
<b>Thursday 13<sup>th</sup> June</b>	<b>RISE Parent Carer Workshop: Looking after our mental health.</b>
<b>Wednesday 19<sup>th</sup> June</b>	<b>New Reception Parents Welcome Meeting 6:15pm</b>
Friday 21 <sup>st</sup> June	KS2 Big Gig 'Hello Sunshine'
Tuesday 25 <sup>th</sup> June	Hoopstarz
<b>Wednesday 26<sup>th</sup> June</b>	<b>New Nursery Parents Welcome Meeting 6:15pm</b>
Monday 1 <sup>st</sup> July	Year 4 Leaver's Video Filming
Wednesday 3 <sup>rd</sup> July	Year 4 transition to GEMs
Thursday 4 <sup>th</sup> July	Year 4 transition to GEMs
Thursday 4 <sup>th</sup> July	In school transition to new classes
Friday 5 <sup>th</sup> July	Year 4 transition to GEMs
Thursday 11 <sup>th</sup> – Friday 12 <sup>th</sup> July	Mr H Onsite Residential for Year 3 children
Friday 19 <sup>th</sup> July	Last day of term

## Staff Training Days

Staff Training Days for GST schools this academic year will be:

- Monday 3<sup>rd</sup> June 2024

## Rainbow Wraparound

Please contact us via

[wraparound@gosforthpark.newcastle.sch.uk](mailto:wraparound@gosforthpark.newcastle.sch.uk)

or for any ad hoc bookings

**Rainbow Wraparound: 07926 946 565.**



If you don't already, please give us a follow on Twitter. Our school account is @GosforthPark1st

# GPFS PTFA PAINT and SIP



Join us for a unique fun filled Paint Party !  
Unleash your creativity and create your own masterpiece with plenty of  
1 to 1 hints and tips from our experts, making this event suitable for  
beginnings and painters of all levels.

There is a great range of drinks and food available to order  
from the bar (alcohol is not included with tickets for this venue).

#### Included:

Group painting class with our professional Artists.  
All materials that you need, canvas, paints (acrylic), apron, brushes etc.  
One to one advice, a great atmosphere, music and a ton of fun.

At the end of the event you get to take  
your masterpiece home and keep forever.

- Friday 21st June

- 7pm - 9pm

- Brandling Arms Gosforth, Gosforth,

Newcastle upon Tyne NE3 1HE

£ 27







# HANDBALL TOURNAMENT

YEAR 2 TO YEAR 11



8TH JUNE 2024  
AT  
BENFIELD CENTRE  
FOR SPORTING EXCELLENCE  
NE6 4NU

**FUN - FRIENDLY - INCLUSIVE**

CAKE SALE  
+  
CHOCOLATE  
RAFFLE

£6 per child

Sign up today by scanning  
the below QR code or email

[NEWCASTLEVIKINGS@GMAIL.COM](mailto:NEWCASTLEVIKINGS@GMAIL.COM)

sponsored by

*Hay & Kilner*





# Is having a diagnosis of learning disability and/or autism important for you as a family?

**Inclusion North is exploring this on behalf of Newcastle City Council.**

**The council want to understand what changes are needed to give parents and carers good support.**

**We would like to hear about your experience of getting a diagnosis of a learning disability or autism for your child or young person.**

**We have made a short survey for people living in Newcastle.**



**This survey is for parents and carers of children or young people who have a learning disability or who are autistic.**

**We welcome responses from everyone even if your child doesn't have a diagnosis.**

**Please scan the QR code. It will take you to the online survey.**



**Inclusion North exists to make inclusion a reality for all people with a learning disability, autistic people and their families.**



# What Parents & Educators Need to Know about SHOPPING PLATFORMS

For people looking to make purchases on their phones, several shopping apps – such as Temu – allow users to buy goods at reduced prices. Others, like Vinted and Depop, let you sell items you no longer want. As internet shopping continues to grow, however, so does the risk of scammers, hackers and breaches of privacy.

## WHAT ARE THE RISKS?

### MISSING ITEMS

Users of Vinted, Depop and Temu have reported not receiving their products despite payment being taken. Users can initially contact the seller to query a missing item, and they have between two and five days (depending on the app) to tell the company what has happened. However, once the money has reached the supposed 'seller', it can be quite difficult to get back.

### SCAMMERS AND PHISHING

Scammers are always on the lookout for unsuspecting buyers or sellers. Common tactics include cancelling shipment of an item once the payment has been processed or asking to conclude the chat and payment outside of the app, where the victim is no longer protected by the buyer protection plan. This should, naturally, be avoided at all costs.

### DATA MISUSE

Apps of all kinds frequently collect our data, often asking for more information than is necessary to set up an account. Data gathered in this way is then usually sold on to third parties for marketing purposes. Lately, certain apps have been under scrutiny for using spyware to track their members' activities – but all too often, the user's consent to this practice has been hidden away in the terms and conditions.

### FAKES OR REPLICAS

It's certainly not unheard of for poor-quality products to be falsely marketed as luxury items, using misleading pictures or clever wording. These disingenuous sales are sometimes outed by suspiciously low price tags, but this isn't always the case. For children and young people especially, there's a risk that the promise of bagging a high-end item for a fraction of its usual price will outweigh any suspicions they may have.

### SLOW REFUNDS

While all apps offer a refund if the product is damaged or doesn't match the description, it can take up to a month to be compensated for this. For many people (especially during a cost-of-living crisis) that can be a long time to be without both the product you bought and the hard-earned cash you spent on it.

### MISLEADING DESCRIPTION

Some people will be able to notice when, say, a product's photo and its description don't seem to match. This isn't a reliable means of picking up on misleading marketing, however – especially not for children and young people, many of whom may not yet realise that such practices even exist. While it's illegal to advertise one thing and sell another, plenty of shady traders use clever wording and omissions to get around this.

## Advice for Parents & Educators

### ALWAYS STAY ON THE APP

It's vital that users pay for any goods through the same app on which they found them, to ensure they are covered by buyer protection. This means users can access support if the item arrives damaged, isn't as described, or doesn't arrive at all – allowing them to seek compensation for the loss. Such regulations can't protect you, however, if you didn't do the deal through the app in question.

### BE WARY OF PHISHING ATTEMPTS

Scammers frequently send messages within these apps to steal personal and financial information from other users. Don't respond to these messages – and under no circumstances should you follow any links they contain. Check for spelling errors, as well as inspecting the name of the sender. Report any suspected phishing emails to the app's help centre – and notify your bank if you think your financial information has been compromised.

### CHECK REVIEWS

Take time to read the reviews and comments left by other users – not just of products, but of sellers and buyers, to ensure they're legitimate and reliable. Before buying an item online, check the reviews for comments about the product's quality, the seller's communication and the delivery time. If you're selling, check the reviews of your buyer for red flags such as frequent requests for refunds or claims of 'missing' items.

### KEEP SAFE AS A SELLER

Sellers can be exploited just as much as buyers. Some users may purchase an item, for example, then pretend it didn't arrive to secure a refund. Always take photos of the shipping label, along with a picture of you posting the item. Send the package's tracking number to the buyer and keep a copy for yourself, letting you investigate any future claims that it never arrived. When taking photos of items you're selling, ensure nothing personal is in the background.

### Meet Our Expert

Dr Claire Sutherland is an online safety consultant at BCyberAware, who has developed and implemented anti-bullying and cyber safety workshops and policies for schools. She has written various academic papers and carried out research for the Australian government comparing internet use and sexting behaviours of young people in the UK, USA and Australia.



#WakeUpWednesday

The National College

Source: See full reference list on guide page at [nationalcollege.com/guides/shopping-apps](https://nationalcollege.com/guides/shopping-apps)



@wake\_up\_weds



/www.thenationalcollege



@wake.up.wednesday



@wake.up.weds

Users of this guide do so at their own discretion. No liability is entered into. Current as of the date of release: 24.04.2024





# INTRODUCING BETTER SWIM SCHOOL AT EAST END POOL

Make your child's time in the water unforgettable with Better Swim School. With our passionate teachers and supportive environment, we're dedicated to not only teaching vital swimming skills for life, but also creating a lifelong passion for the water. Here's how we make it happen:

- Accredited teaching programme tailored to children aged 4-16 years
- Interactive lessons designed to boost water confidence and skills
- Certified swim teachers committed to your child's safety and development
- Ability-based lessons to ensure targeted attention and rapid advancement
- Consistent lesson day and times for uninterrupted progress through levels
- Unlimited public swim access outside of lessons for extra practice and fun

Discover how Better Swim School at your local leisure centre can provide your child with lifelong swimming skills.

Join Better Swim School's weekly lessons at East End Pool and get **50%** off your first payment with code **JOIN50** at checkout.

Visit [better.org.uk/swim-school](https://better.org.uk/swim-school) or search Better Swim School to join and discover more.

Terms and conditions apply. Offer open to new customers only. Offer available at East End Pool only. Offer ends 13th May 2024. Full terms at [better.org.uk/better-swim](https://better.org.uk/better-swim). Better is a registered trademark and trading name of GLL (Governaux Leisure Limited), a charitable social enterprise and registered society under the Co-operative & Community Benefit & Societies Act 2014 (company no. 2777134). Registered office: Mollington House, The Ryed, Arsenal, London, SE18 6SL. Income Revenue Charity no. 5843796.

**BETTER**